

Coming Soon! Franklin Ave Storefront

2525 EAST FRANKLIN AVENUE, #100, MINNEAPOLIS, MN 55406

Join a vibrant tenant mix in a desirable, highly connected location



Building Highlights

- New redevelopment in progress
 - Wood Floors
 - New Storefront Windows
 - New ADA Bathroom
 - Available Summer 2017
- Great location among other locally owned small businesses, mix of nonprofit office tenants already in building
- Redesign is building owner

UNIT INFORMATION

1045 Usable/1267 Net Rentable SF
Common restrooms, break room
\$16 net + \$5.65 CAM + Gas/Elec

NEIGHBORHOOD

Seward Neighborhood
Stoplight/I-94 Exit Corner
15,800 cars/day
Strong business association

Nearby Businesses: Seward Coop Creamery, Wells Fargo Bank, Soberfish, CHILD Daycare, ArtiCulture, Landreau Insurance Group, Voices for Racial Justice, Cycles for Change, Alliance for Metropolitan Stability, Somali Action Alliance, Redesign



CONTACT

Renee Spillum
612-435-0279

renee@redesigninc.org

PROPOSED FLOOR PLAN

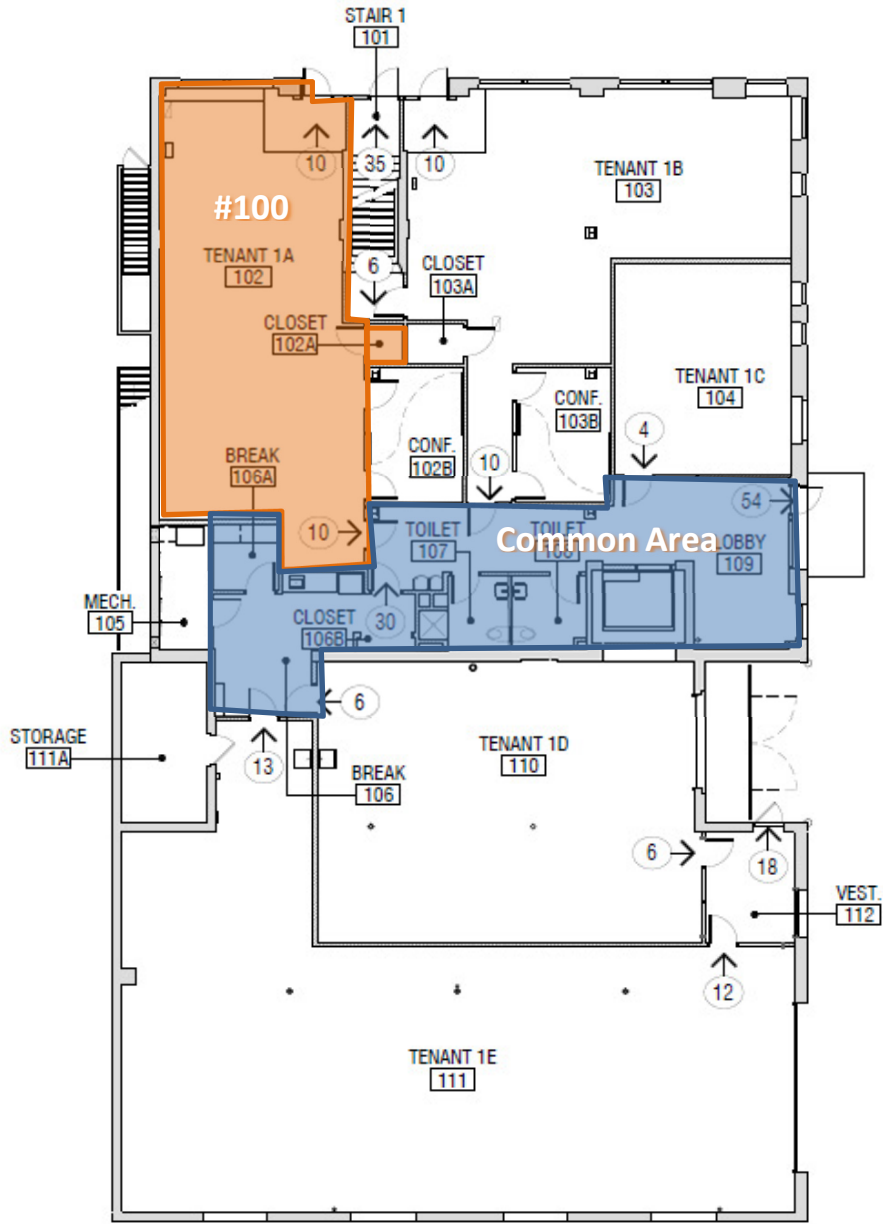

PROPOSED ELEVATION

